

TILLAMOOK COUNTY SURVEYORS OFFICE  
TILLAMOOK COUNTY COURT HOUSE  
201 LAUREL AVENUE  
TILLAMOOK, OREGON 97141

1/4 CORNER COMMON SECTIONS 29 & 32 T.3N., R.10W., W.M.

1 S 29 I found a 2" iron pipe with a 3" T.C.S. Brass Cap in  
/ +----- a 10" tile and concrete, approximately 12" deep, (See  
4 S32 T.C.S. Rewitness card #150). I set a 10" cast iron  
RS 287 monument case around the found monument and encased  
1974 in concrete.

History of found monument

I found this monument to be as described on T.C.S. Rewitness Card #150 and the references found and/or set at that time to now be as follows:

Power pole N.51°W. 66.10'; (Now gone).

Telephone pole S.80°E. 34.80'; (Now gone).

86" hat section post East 24.5'; (Now gone).

New Accessory

Power pole #294112 N.51°W. 63.05'. The distance was measured to a nail with a T.C.S. Brass washer in a scribed triangle on the Westerly side of the pole.

NW corner of the golf course clubhouse foundation bears S.35°E. 59.70'.

\*indicates Tillamook County Surveyors yellow metal location poster attached.

Surveys and Rewitnesses of Record  
(not listed on Rewitness card #150)

A-2848	1975	Colin H. Handforth	P.E. 3510
C-378	1976	Colin H. Handforth	P.E. 3510
B-1133	1983	John E. Hollingsworth	L.S.691
P-3	1990	Gene A. Leuthold	L.S.475
Rewitness Book 6 at Page 247 & 248		John E. Hollingsworth	L.S.691

Location of Monument

This corner is located on the East side of Necarney Blvd. and on the South side of a paved apron on to Lake Drive.

In the presence of Al Dvorak and Dan McNutt

October 17, 1992

Title:

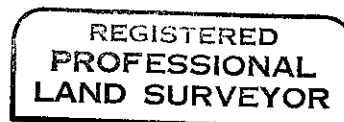
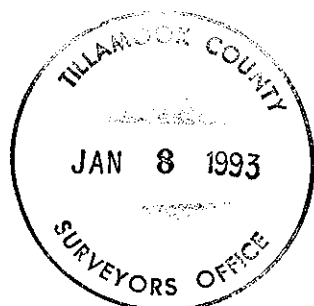

*Allan E. Duncan, C.S.*

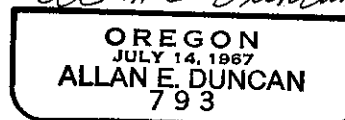

Expires 12-31-93